

14 x 14M THICKNESS 14CM SPRUNG FLOORS WITH MOUNTED & NOT MOUNTED SPRINGS «MONTREAL» EVOLUTION COMPETITION EXERCISE FLOOR M'20

6785A - 6787A
6775D - 6775D/DE
6776C - 6776C/DE

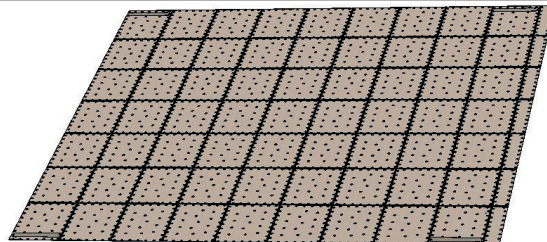

6775D & 6775D/DE
6776C & 6776C/DE



**KEEP THIS
DOCUMENT**

Warning:

This equipment should be installed by a qualified individual. This equipment should only be used by one person at a time, under the supervision of a qualified individual.

Using this equipment for purposes other than those originally intended is prohibited.

Compliance:

14 x 14 m Exercise floors references **6775D - 6775D/DE et 6776C - 6776C/DE** are FIG approved.

Recommendations:

- Keep these instructions for subsequent reference (inspection, maintenance, etc.).
- Periodically carry out predictive maintenance.
- Depending on how much it is used have the equipment serviced yearly or every few years.

Maintenance:

IMPORTANT :

- Regular cleaning of the exercise floor makes it easier to spot any problems (distortion, breakage or moisture absorption).
- Check on the presence and condition: of the profiles **(8), (9), (10), (11) & (12)** and linking plates **(13) & (14)** properly locked.
- Check the condition of the floor: wood panels **(4), (5), (6) & (7)**, springs **(2)** and plastic parts **(1) & (3)**,
- Check the condition of the floor anti-rotation kit **(NM277)**.
- Check the condition of the foams area **(NM285 or NM299)**, and the carpet **(NM254)** or roll-up tracks **(NM286)**.
- Any damaged or distorted component should be replaced as quickly as possible.

Composition :

1/ 14 x 14M «MONTREAL» EVOLUTION COMPETITION EXERCISE FLOOR WITH MOUNTED & NOT MOUNTED SPRINGS CARPET VERSION (REF.: 6775D & 6775D/DE):

- Overlay carpet 14 x 14m (Ref: 6380H) -> Detailed Pack list: refer to instructions NM254.
- Set of 4 finishing bibs 14m (Ref: 6575/10): Volume 0.06 m³, Weight 9.5 kg, Dimensions 600 x 420 x 240 mm -> instructions NM299.
- Impact-absorbing foam area 14 x 14m - thickness: 56 mm (Ref: 6788B) -> Detailed Pack list: refer to instructions NM299.
- High elasticity floor 14 x 14m with springs mounted (Ref: 6785A) or springs not mounted (Ref: 6787A).
- Floor Anti-Rotation Kit - 4 adjustable cables (Ref: 6529/00) -> Detailed Pack list: refer to instructions NM277 (included in floor).

2/ 14 x 14M «MONTREAL» EVOLUTION COMPETITION EXERCISE FLOOR WITH MOUNTED & NOT MOUNTED SPRINGS ROLL-UP TRACKS VERSION (REF.: 6776C & 6776C/DE):

- Gymnastics Area 14x14m th. : 3.8cm «Montreal» evol. Comp. Exercise floor M'20 (Ref.: 6776/00) -> Detailed Pack list: refer to instructions NM286.
- Set of 4 finishing bibs 14 m (Ref: 6575/10): Volume 0.06 m³, Weight 9.5 kg, Dimensions 600 x 420 x 240 mm -> instructions NM286.
- Foam underlay 14x14m thickness: 24mm Exercise floor M'20 (Ref.: 6776/10) -> Detailed Pack list: refer to instructions NM285.
- High elasticity floor 14 x 14 m with springs mounted (Ref: 6785A) or springs not mounted (Ref: 6787A).
- Floor Anti-Rotation Kit - 4 adjustable cables (Ref: 6529/00) -> Detailed Pack list: refer to instructions NM277 (included in floor).

Pack list:

PACKAGES REF.	6529/00 Floor ARK Ex. Floor M'12	6785/80 Pallet 21 panels + 7 edges	6785/90 Pallet 19 panels + 2 corners	6585/19 Set 12 profiles White Length 30 cm	6785/15 Set 8 prof. White Length 1.3 m	6785/16 Set 30 prof. Grey Length 1.4 m	6785/17 Set 20 prof. White Length 1.8m	6785/18 Set 29 prof. Grey Length 1.9m	6785/60 Pack 66 plates White/Grey	6785/70 Pack 34 plates White	6785/100 Pack 5 springs + fixings	Nber of pack.
6785A High elasticity floor 14 x 14 m springs mounted	1	1	2	1	1	2	1	2	1	1	1	14
VOLUME (m³)	0.013	6.5	5.5	0.002	0.01	0.03	0.02	0.03	0.03	0.03	0.005	
WEIGHT (KG)	4.2	836	758	2	4	15	15	22	3.64	2	1.2	
SIZE (MM)	310x210x200	2020x1510x2130	2020x1510x1820	310x150x50	1300x170x50	1400x170x110	1800x170x80	1900x170x80	410x320x230	400x310x230	200x160x150	

PACKAGES REF.	6529/00 Floor ARK Ex. Floor M'12	6787/40 Pallet 32 panels + edges	6787/50 Pallet 27 panels + 4 corners	6585/19 Set 12 prof White Len- gth 30 cm	6785/15 Set 8 prof. White Length 1,3m	6785/16 Set 30 prof. Grey Length 1.4 m	6785/17 Set 20 prof White Len- gth 1,8m	6785/18 Set 29 prof. Grey Length 1,9m	6785/60 Pack 66 plates White/Grey	6785/70 Pack 34 plates White	6787/20 Pack 113 springs only	6787/30 Pack 1356 lower supports	6785/100 Pack 5 springs + fixings	Nber of pack
6787A High elasticity floor 14 x 14 m springs not mounted	1	1	1	1	1	2	1	2	1	1	24	2	1	39
VOLUME (m³)	0.013	3.21	2.87	0.002	0.01	0.03	0.02	0.03	0.03	0.03	0.05	0.21	0.005	
WEIGHT (KG)	4.2	982	909	2	4	15	15	22	3.64	2	20.2	20	1.2	
SIZE (MM)	310x210x200	2030x1520x1040	2030x1520x930	310x150x50	1300x170x50	1400x170x110	1800x170x80	1900x170x80	410x320x230	400x310x230	360x360x360	1300x600x270	200x160x150	

I. Assembling the floor not mounted springs (Ref.: 6787A) of exercise floors Refs.: 6775D/DE & 6776C/DE :

Figures 1 & 2 - Clipping of springs and lower supports under floor panels

- Align vertically: the lower support (1), the spring only (2) and the upper support (3) screwed to the floor panels (p).
- Press hard on the lower support (1) to solidarize the elements simultaneously.
- The two «clacks» ensure that the three elements are correctly connected.

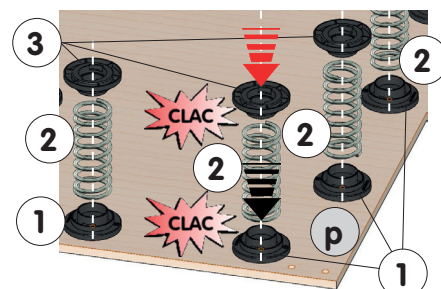
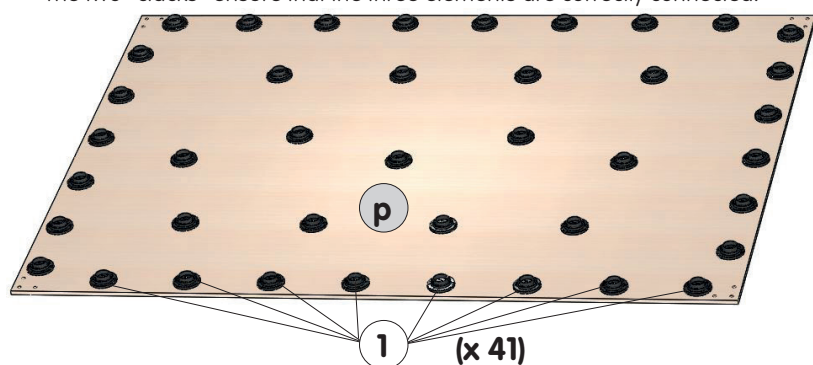

II. Assembling the floor: (2 minimum).



IMPORTANT: CHECK THAT THE PACKAGING TUBES (†) OF THE PANELS (REF.: 6785A) ARE COMPLETELY REMOVED DURING ASSEMBLY.

STORE THEM FOR FUTURE STORAGE AND/OR TRANSPORT.

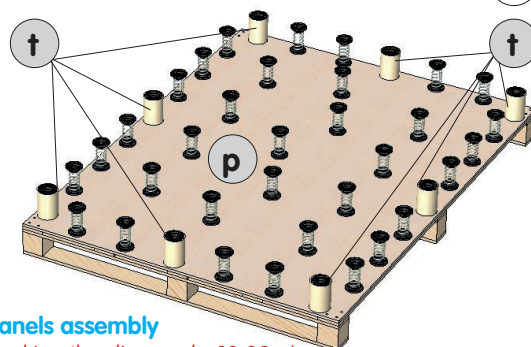
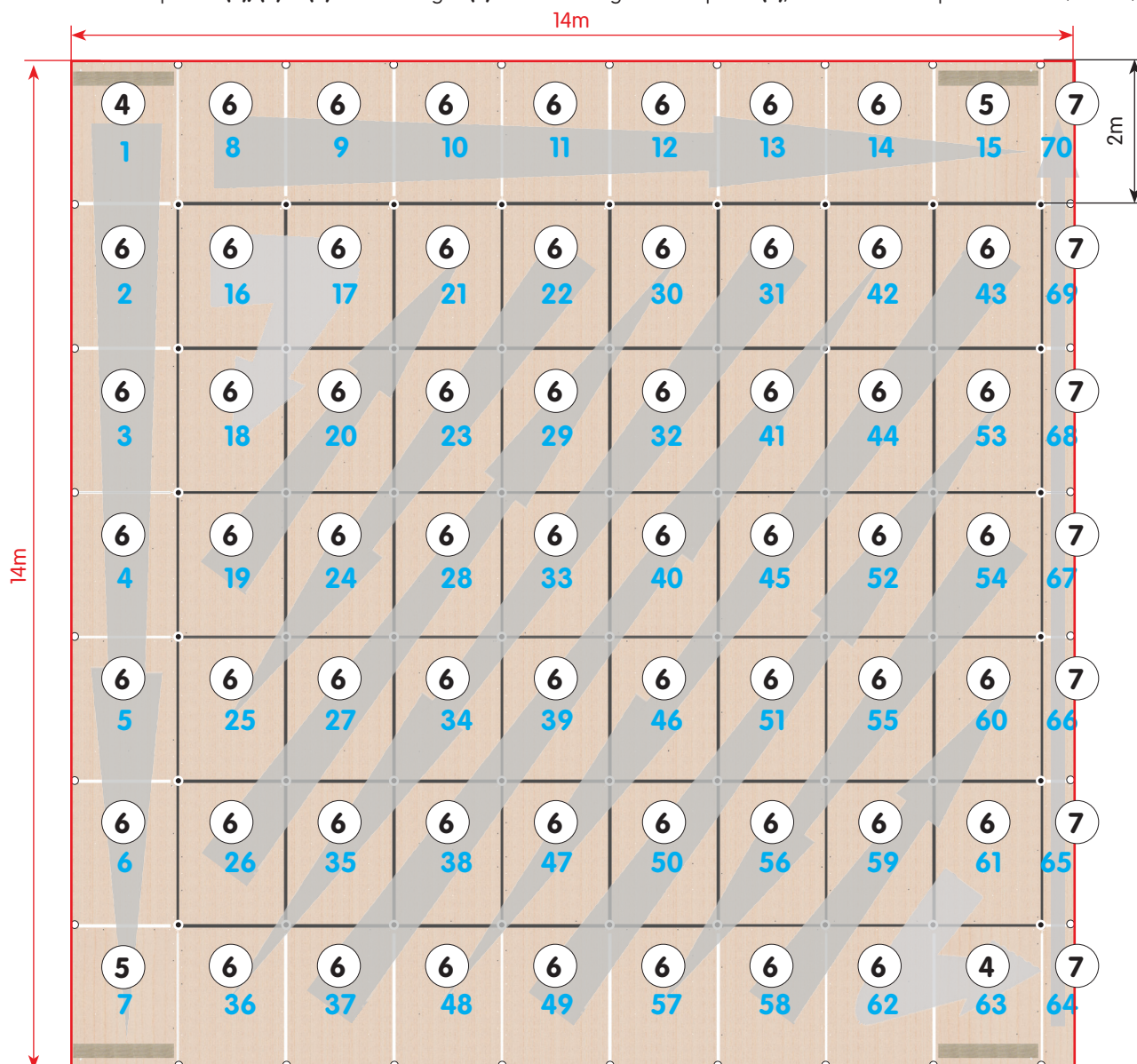

Figure 3 - Arrangement and order of the panels assembly

- On the ground, mark the overall dimensions of the floor: a 14 x 14 m square (Checking the diagonals: 19.82m)
- Assemble the 63 panels (4), (5) & (6) and the edges (7): start with 1 right corner panel (4), then follow the specified order (Blue N°)



Figures 4, 5, 6, 7 & details - Orientation of the 4 corner panels



ATTENTION, THESE 4 PANELS (4) AND (5) ARE EQUIPPED WITH:

- Hook-and-loop strips (**m**) of the foam ARK, to be placed on the periphery of the floor
- And guying plates (**h**), provided for the hooking of the cables (**c**) of the floor ARK, to be orientated towards the interior of the floor.

Right corner panel - Top & Bottom Views

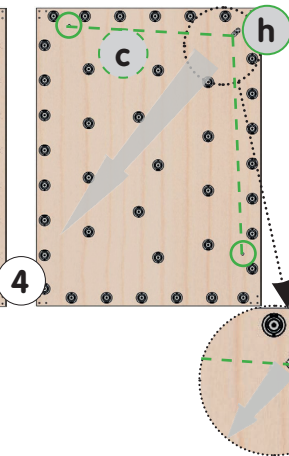
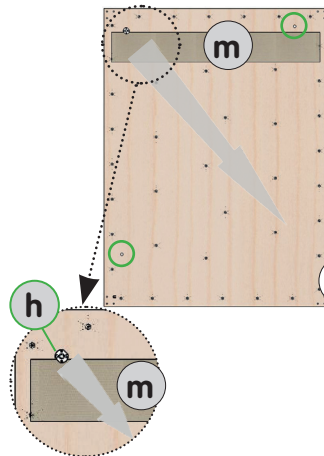

Left corner panel - Bottom & Top Views

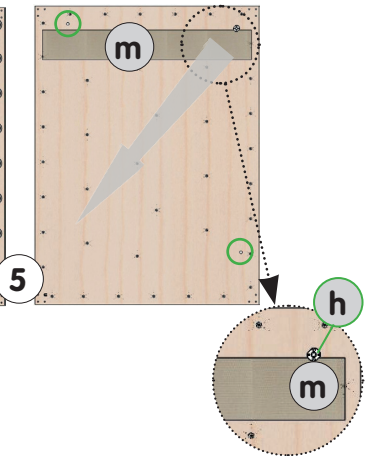
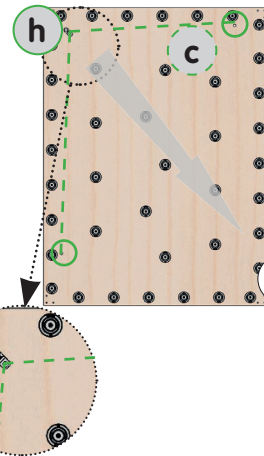

Figure 8 - Distribution of floor panels and connecting parts

- Assemble the white profiles (**10**), (**11**) & (**12**) and the white locking plates (**14**) on the periphery of the floor (Connection 2 panels).
- Assemble the grey profiles (**8**) & (**9**) and the white & grey locking plates (**13**) on the central part (Connection between 4 panels).

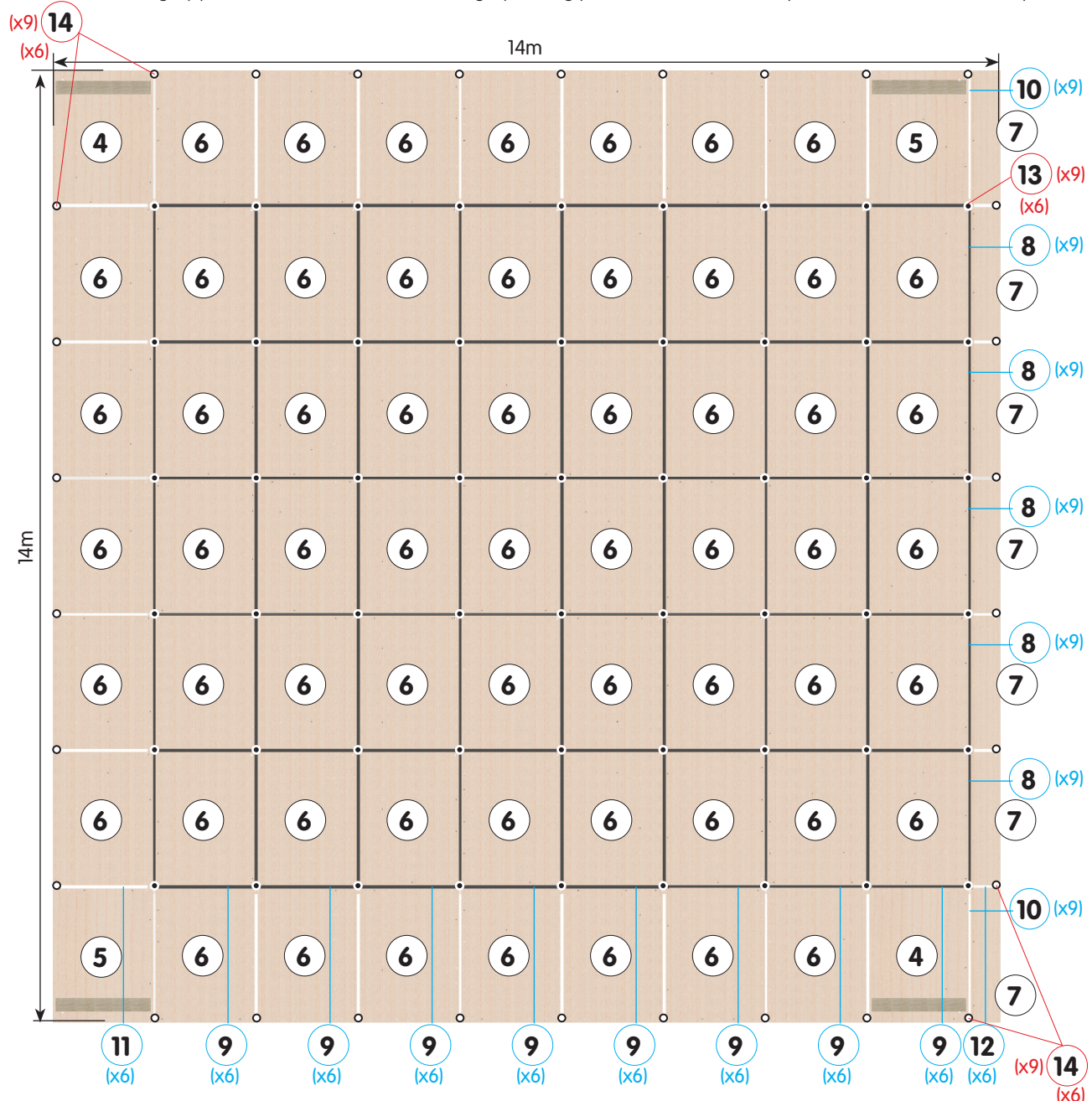

Figure 9 & details - Installation of the connecting parts

- Mount the locking plates (13) & (14) and the profiles (8), (9), (10), (11) & (12) as the panels are assembled.
- Center the profiles on each side of the floor panels (4), (5) & (6).
- Lock the plates (13) & (14) ✓.

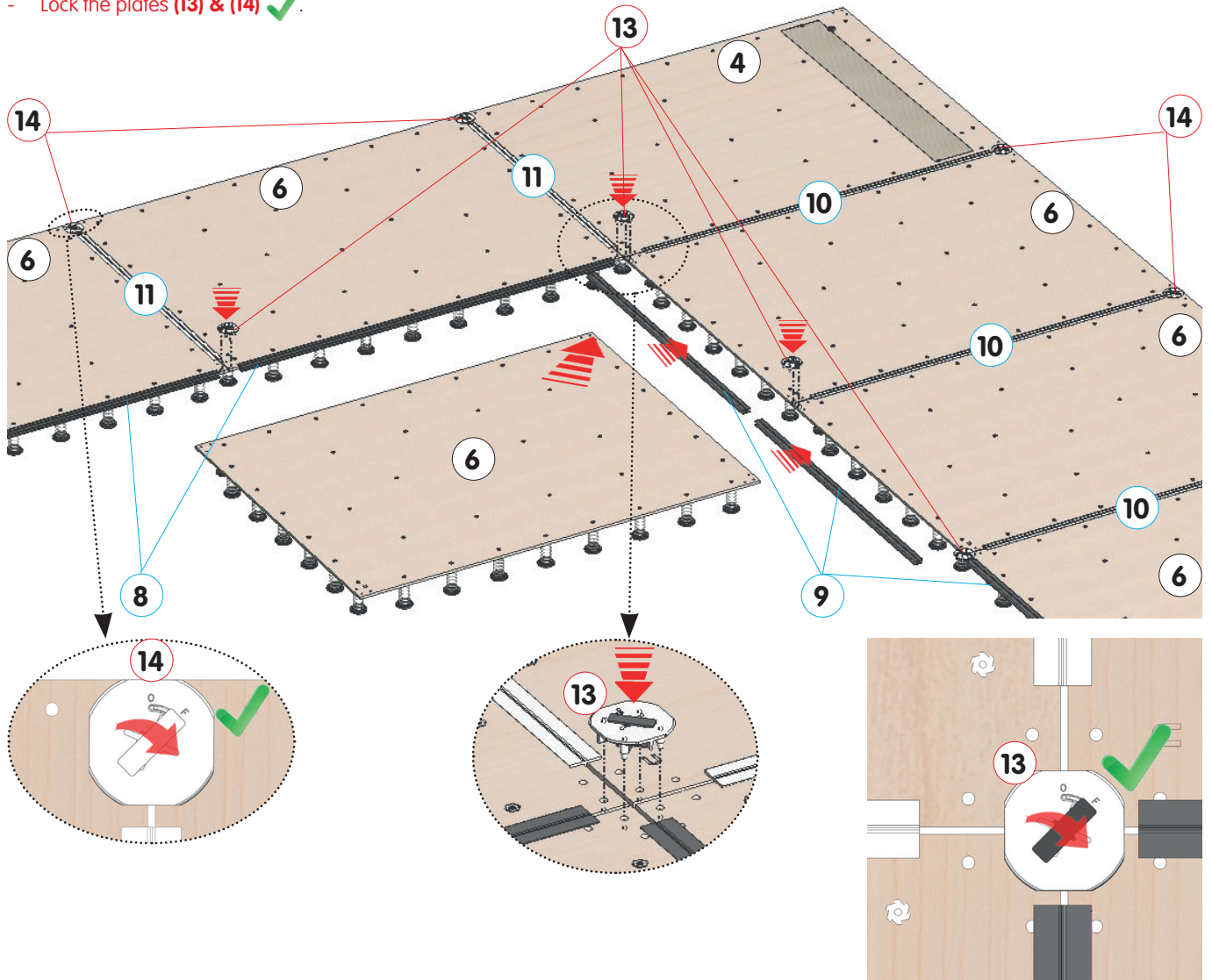
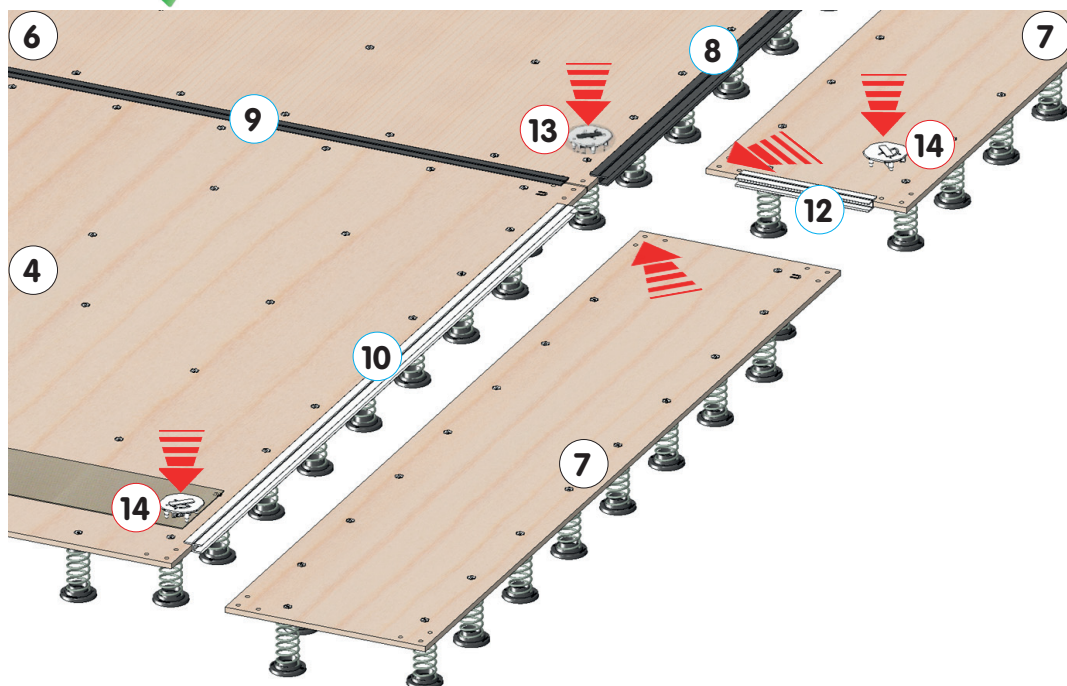

Figure 10 - Installation of the edge panels

- Install the 4 cables of the Floor Anti-Rotation Kit (15) according to instructions NM277.
- Finish by assembling the 7 floor edge panels (7).
- Lock the plates (13) & (14) ✓.



STOPPER CABLES AND ANTI-ROTATION KITS FOR 14 x 14 M & 13 x 13 M FLOORS OF SPRUNG EXERCISE FLOORS M'16.

**6529/00
6529D**

KEEP THIS
DOCUMENT

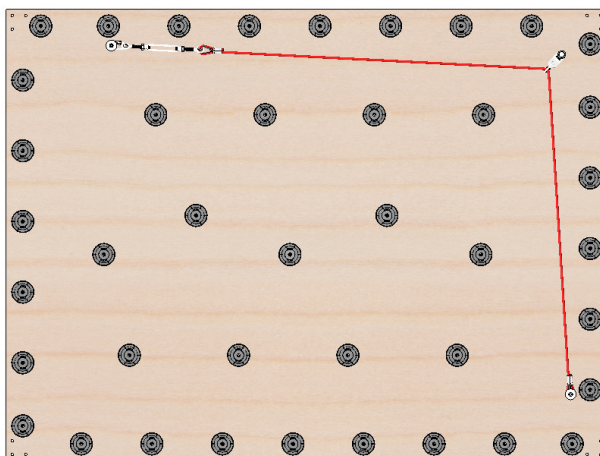

Warning:

This equipment should be installed by a qualified individual. The attachments that are provided with these kits may only be used if the support complies with specification **CC78**. Using this equipment for purposes other than those originally intended is prohibited.

Recommendations:

As set out in French Standard NF S52-400 the following is recommended:

- keep these instructions for subsequent reference (inspection, maintenance, etc.).
- periodically carry out predictive maintenance.
- depending on how often it is used, have the equipment serviced yearly or every few years.

Pack list:

1 Pack (**Ref: 6529/00**) -> Set of 4 adjustable stopper cables + floor attachments:

Weight: 4.5 kg

Dimensions: 310 x 210 x 200 mm

Volume: 0.01 m³

1 Pack (**Ref: 6529D**) -> Set of 4 complete adjustable stopper cables:

Weight: 5.5 kg

Dimensions: 300 x 210 x 200 mm

Volume: 0.01 m³

Uses of stopper cables:

These cables stop the rotation and/or translational motion of the high elasticity floors in GYMNOVA gymnastics sprung exercise floors (Ref: 6775 & 6775/DE - 6777 & 6777/DE).

I. Assembly of Anti-Rotation Kit: minimum

- 1 Locate the 2 holes on each corner panel - Left (1) and Right (2) (symmetrical floor): position of drilled holes for Anti-Rotation Kit attachments.

Corner panel (14 x 14 m Floor)

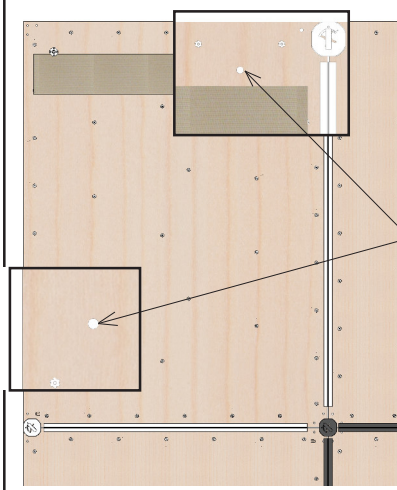

Corner panel (13 x 13 m Floor)

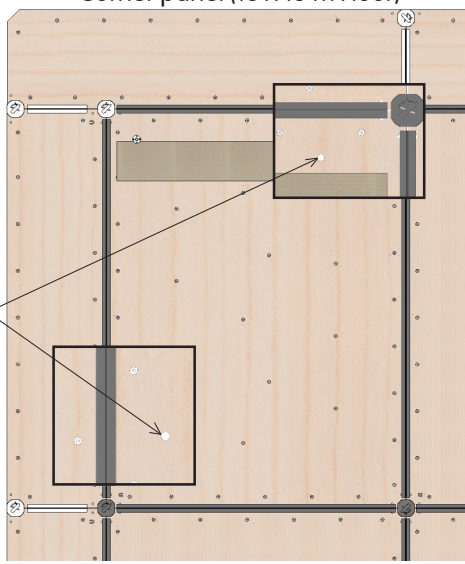

- 2 **Pre-drill the flooring (Ø12mm)** through the holes of the panels

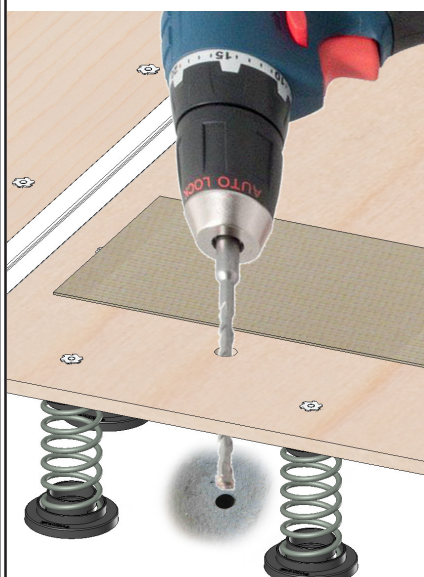

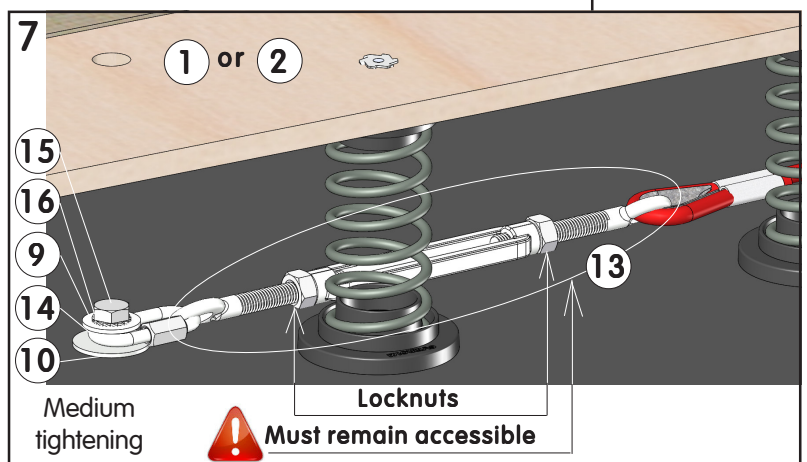
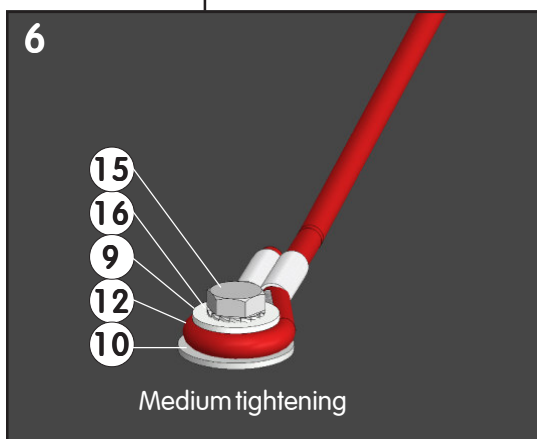
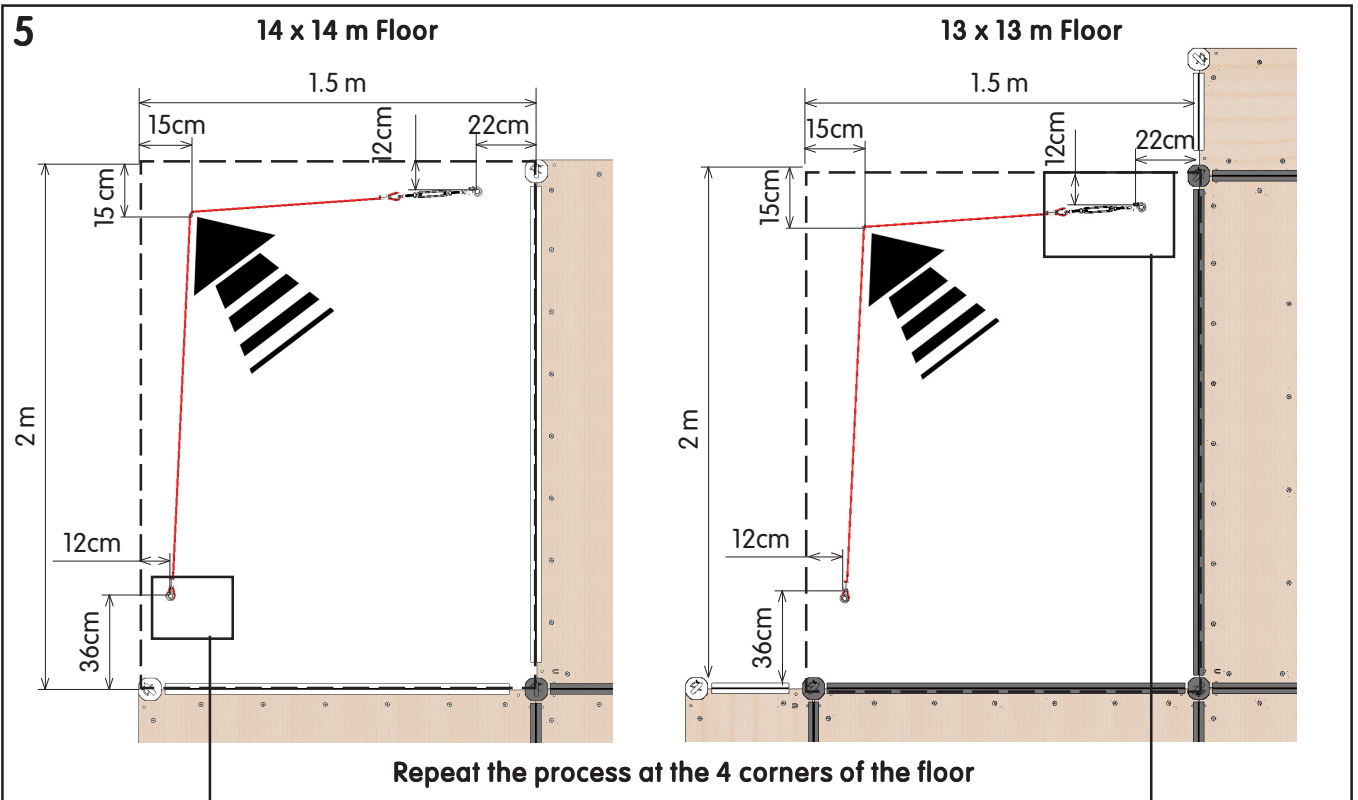
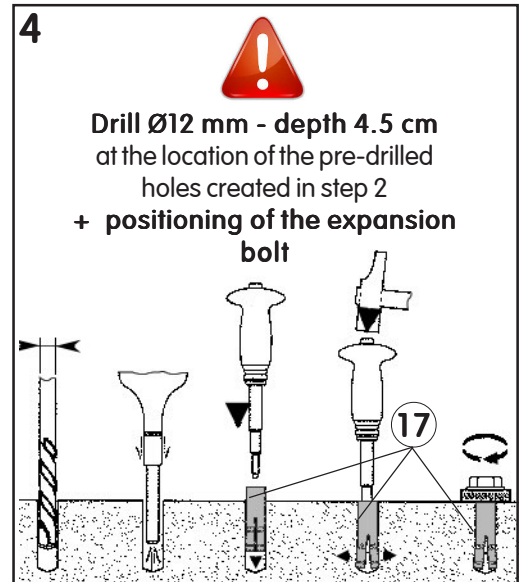
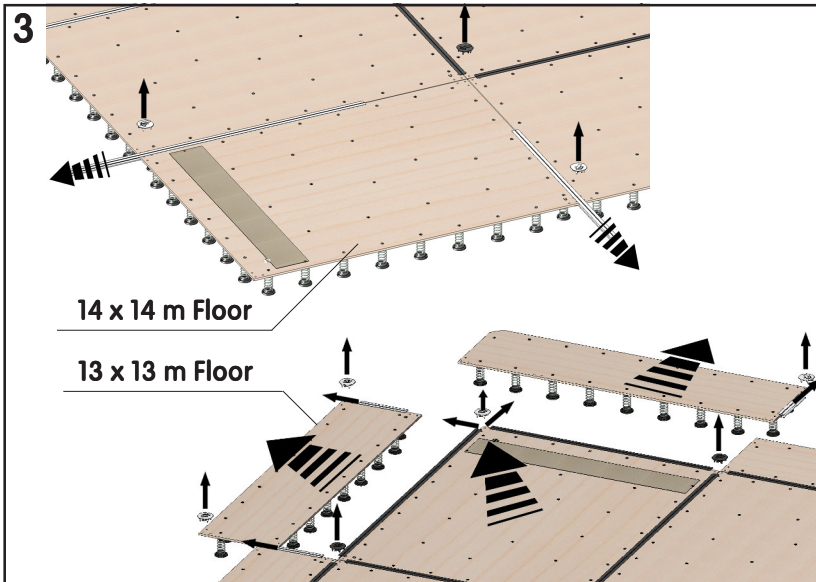

8

14 x 14 m Floor

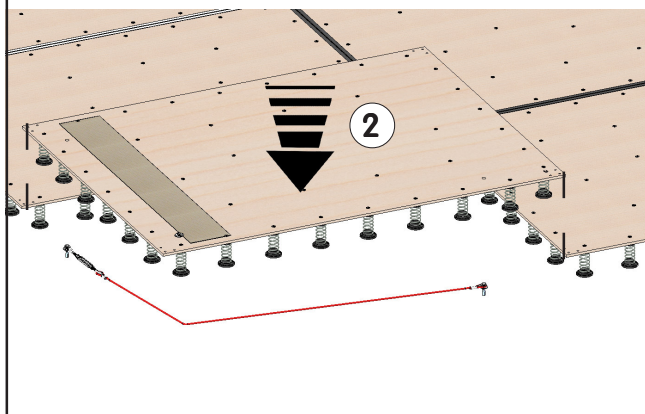

13 x 13 m Floor

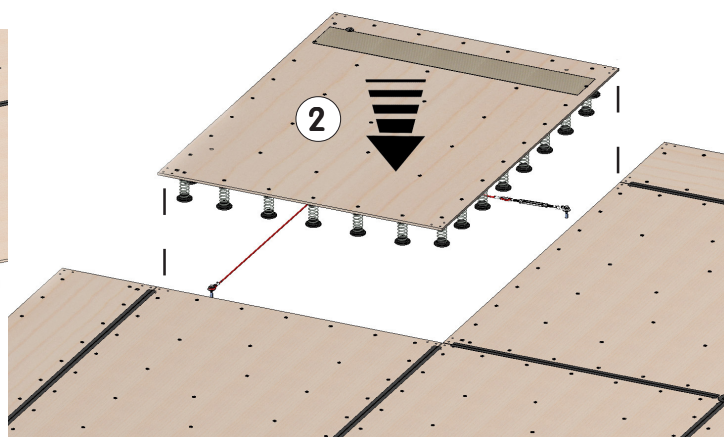

9

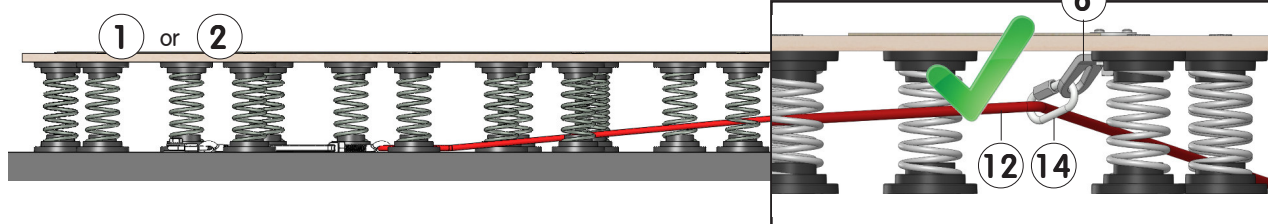

10

14 x 14 m Floor

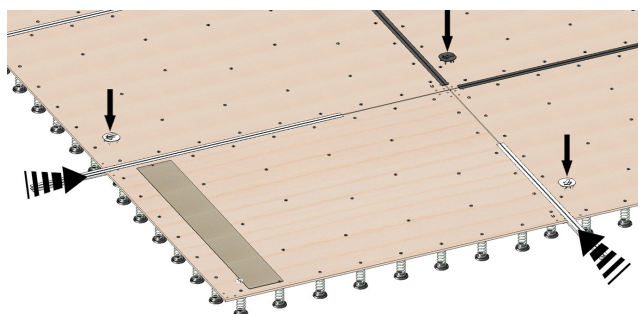

13 x 13 m Floor

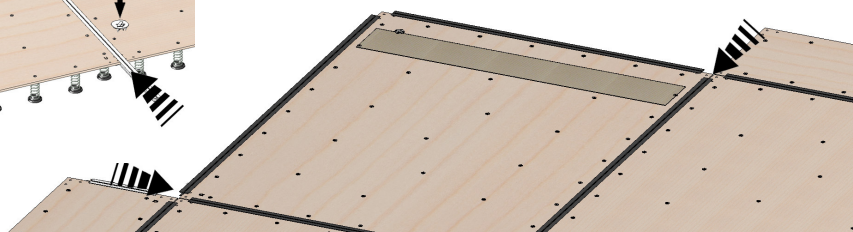

11

Screw in each tensioner (13) so that the cable (12) no longer rests on the floor. Firmly tighten the floor attachments (10, 9, 16 & 15). Hold the tensioner with a screwdriver and lock the locknuts with the spanner.

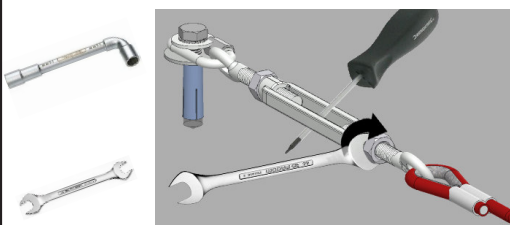

Tube spanner and open end spanner no. 16 or 17.

12

13 x 13 m Floor only

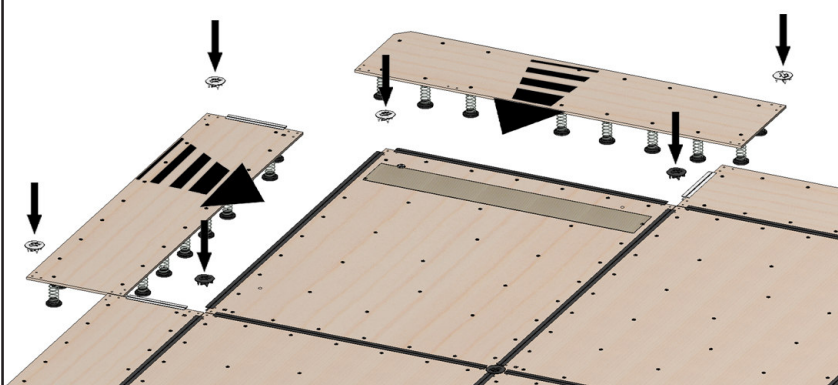

Maintenance:

- Regular cleaning of the floor will make it easier to spot any problems (distortion, breakage or corrosion).
- Before each use, make a thorough check on the condition of the components: wear of bracing flats (6), cables (12), quick links (14) and turnbuckles (13).
- Periodically check the tensioning of cables (11), locking of tensioners (13), and closure of quick links (14).
- Check that the attachments (15) are locked and that the bolts (17) are not coming away from the flooring.

Important:

- If a problem is found or suspected, do not use the equipment until it has been checked by a technician.
- Any damaged or distorted component should be replaced as quickly as possible.

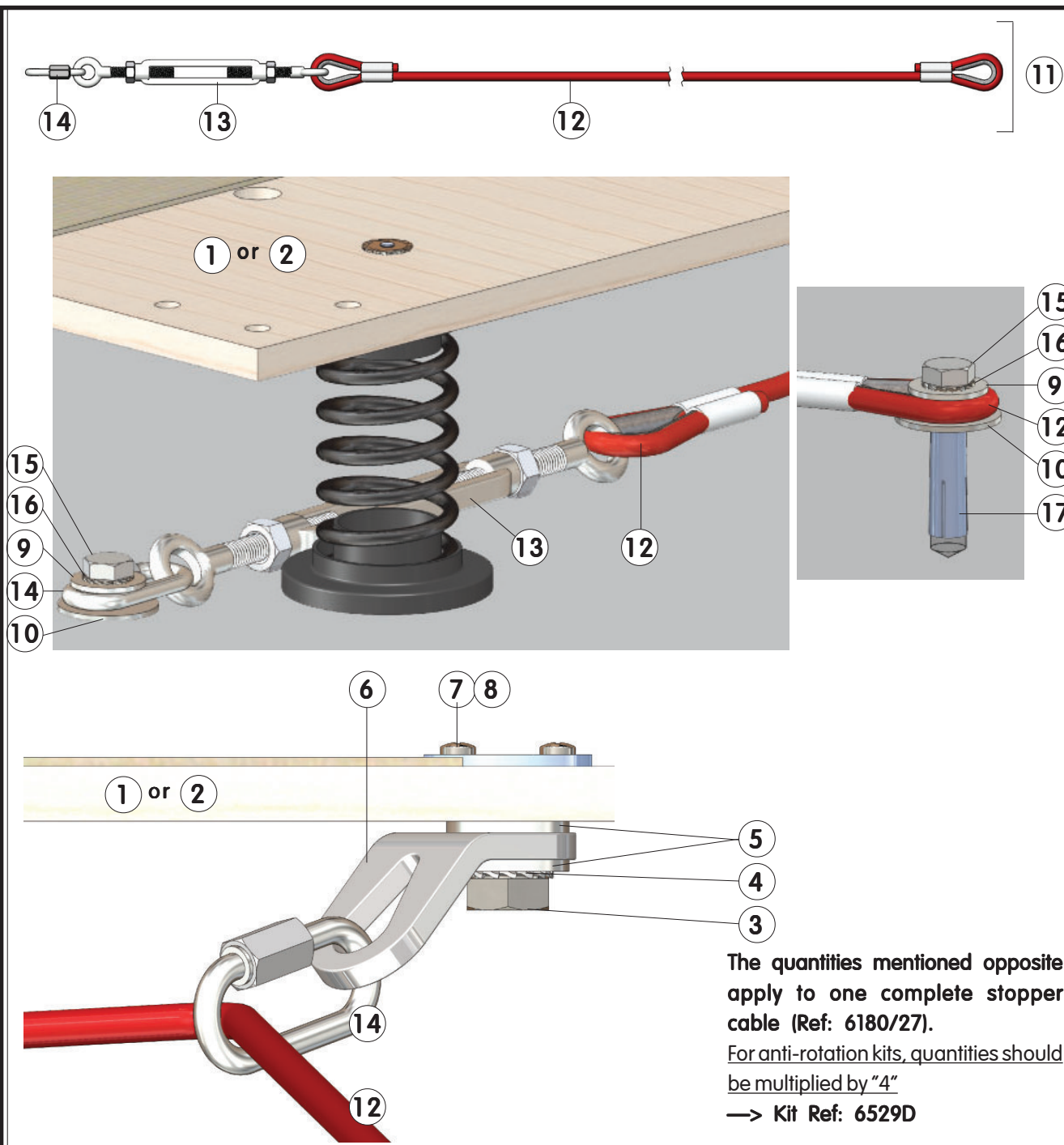

The quantities mentioned opposite apply to one complete stopper cable (Ref: 6180/27).
 For anti-rotation kits, quantities should be multiplied by "4"
 —> Kit Ref: 6529D

To order spare parts, please provide the description, reference and delivery date of the entire apparatus.

30	-	-	-	-
29	-	-	-	-
28	-	-	-	-
27	-	-	-	-
26	-	-	-	-
25	-	-	-	-
24	-	-	-	-
23	-	-	-	-
22	-	-	-	-
21	-	-	-	-
20	-	-	-	-
19	-	-	-	-
18	-	-	-	-
17	2	M10 hammer-type exp. bolt	QCEC100000	Floor attachments
16	2	External tooth lock washer dia. 10 x 18	VREE10180Z	Floor attachments
15	2	H M10 x 30 ZP screw	VH0010030Z	Floor attachments
14	2	Quick link No. 6	QMRA00006Z	1 included in 11
13	1	M10 O/O turnbuckle	QTELE1010G	included in 11
12	1	5.5 dia. cable - length: 2.26 m	-	included in 11
11	1	Adjustable stopper cable	-	each
10	2	LL 10 x 36 flat washer	VRP010360Z	Floor attachments
9	2	L 10 x 27 flat washer	VRP010270Z	Floor attachments
8	2	Pan-head chipboard screw, dia. 4 x 16	VVBZ40016Z	included in 1 and 2
7	1	M12 screw nut	VEAV12210Z	included in 1 and 2
6	1	Bracing flat	X3120/12	included in 1 and 2
5	2	LL 14 x 36 flat washer	VRP014360Z	included in 1 and 2
4	1	External tooth lock washer dia. 12 x 20	VREE12200Z	included in 1 and 2
3	1	H M12 x 25 ZP screw	VH0012025Z	included in 1 and 2
2	-	Right corner panel 2 x 1.5 m	6785/13	-
1	-	Left corner panel 2 x 1.5 m	6785/12	-
ITEM	QTY	DESCRIPTION	REFERENCE	REMARKS
		GYMNOVA	STOPPER CABLES AND ANTI-ROTATION	
		RUE GASTON DE FLOTTE	Kits 14 x 14 m & 13 x 13 m	
		13012 MARSEILLE	FLOORS FOR SPRUNG EXERCISE	
		Tél. : 33-(0)-4-91-87-51-20	FLOORS M'16	
		Fax: 33-(0)-4-91-93-86-89		
		BY: M. CHARBONNEAU	DATE: 07/03/17	Ref.: 6529/00 - 6529D
THIS DOCUMENT IS THE PROPERTY OF GYMNOVA. IT IS CONFIDENTIAL AND SHALL NOT BE REPRODUCED WITHOUT PRIOR AUTHORIZATION				